

Land intended to be exchanged
for Heis.

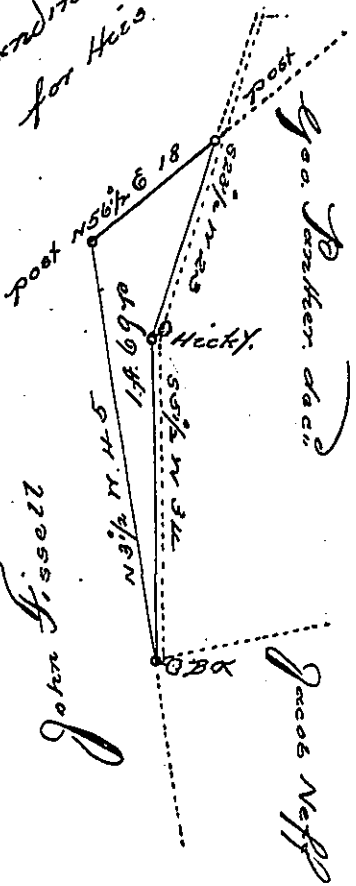

A Draught of one acre & 69^{ths} of Land being part of Geo. Panther, a ^{dec'd} ^{dec'd} Benders Land in Mount Joy Township Lancaster County. Situate on the West of the Road from Lebanon to Andersons Ferry, intended to be given in exchange to John Fisser for 16³/₄ on the east side of said Road.

J. B. Garbraith D.D.
13th. March. 1794

IN TESTIMONY that the above is a copy of the original remaining on file in the Department of Internal Affairs of Pennsylvania, made conformably to an Act of Assembly approved the 16th day of February, 1833, I have hereunto set my Hand and caused the Seal of said Department to be affixed at Harrisburg, this sixth day of Septem^r 1898.

James W. Patton
Secretary of Internal Affairs.